

EB_EBX Series

General Purpose Power-Line Filters (5-200A)



Typical application

- Suppression of industrial radio interference along power lines

Features and benefits

- General purpose
- Compact unit
- Easy installation

Conformity

- CE EN 60939
- CSA C22,2 | available on request for most types
- UL 1283 | available on request for most types
- Climatic category 25/085/21 (IEC 60068-1)

Technical specifications

	Symbol	Value	Unit	Remarks
Rated voltage	V_R	440/250	VAC	
Rated current	I_R	5 ... 200	A	
Ground capacitance		6.8 ... 50	nF	
Operating frequency	f_{op}	50/60	Hz	
Insertion loss		up to 82/82	dB	common/dfferential mode
Leakage current	I_l	---	mA	
Operating temperature	T_{amb}	-25 ... +85	°C	
Storage temperature	T_S	-25 ... +85	°C	
Test voltage - line to line	V_{test}	1500	VDC	
Test voltage - line to ground	V_{test}	2250	VDC	

Electrical properties

Model	Connection		Rated Current [A]	Ground Capacitance [nF]	Discharge Resistance [MΩ]	Circuit Diagram	Package Type
	Line	Load					
DL-5EB	F	F	5	6.8		1	1
DL-10EB	F	F	10	6.8		1	1
DL-5EBX	L	L	5	6.8		1	2
DL-10EBX	L	L	10	6.8		1	2
DL-15EB3	S	S	15	6.8		2	3
DL-20EB3	S	S	20	6.8		2	3
DL-25EB3	S	S	25	6.8		2	3
DL-30EB3	S	S	30	6.8		2	3
DL-40EB3	S	S	40	6.8		2	4
DL-50EB3	S	S	50	6.8		2	4
DL-100EB1	S	S	100	50	0.44	3	5
DL-150EB1	S	S	150	50	0.44	3	5
DL-200EB11	S	S	200	50	0.44	3	6

Legend: F = FASTON 6.3 S = screw terminal L = lead

Circuit schematic

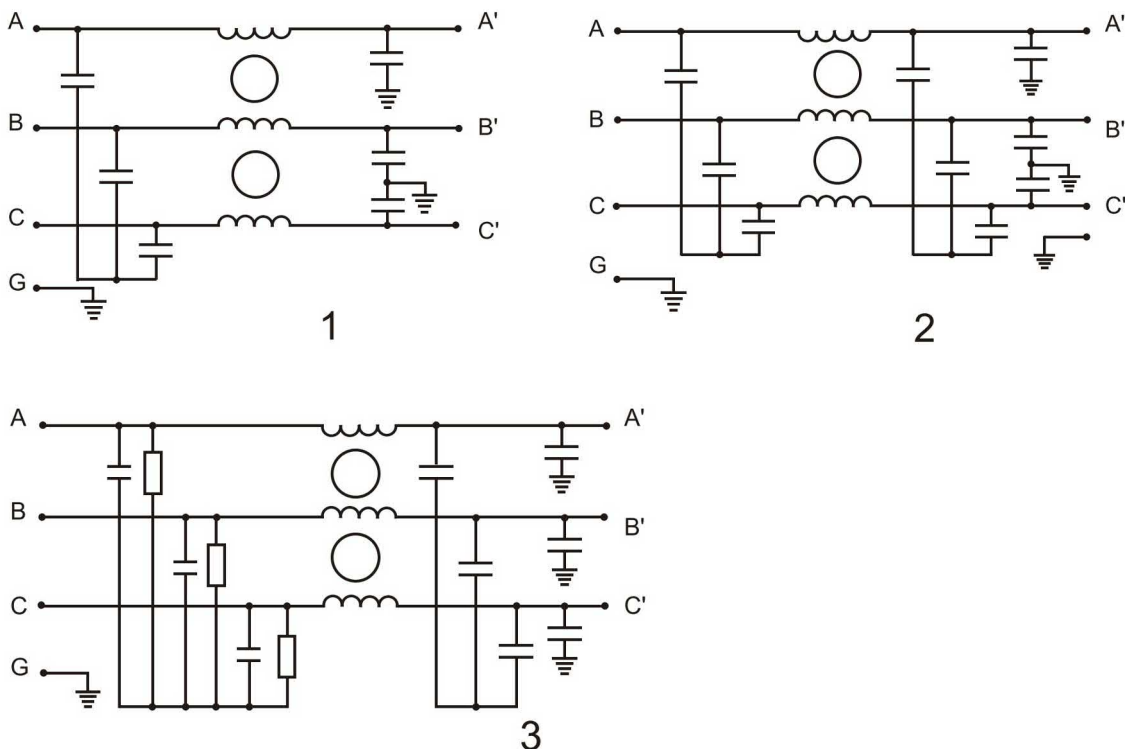

Insertion loss characteristics

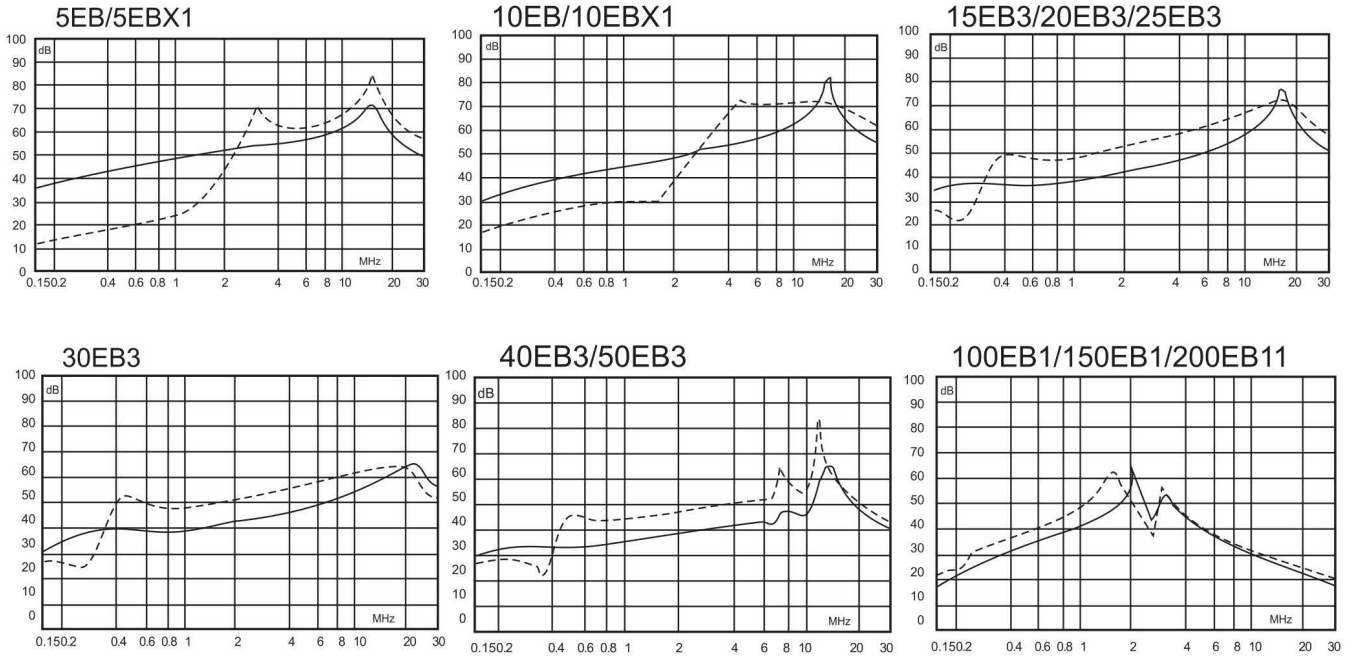

_____ Common Mode
 - - - - - Differential Mode

Mechanical packaging

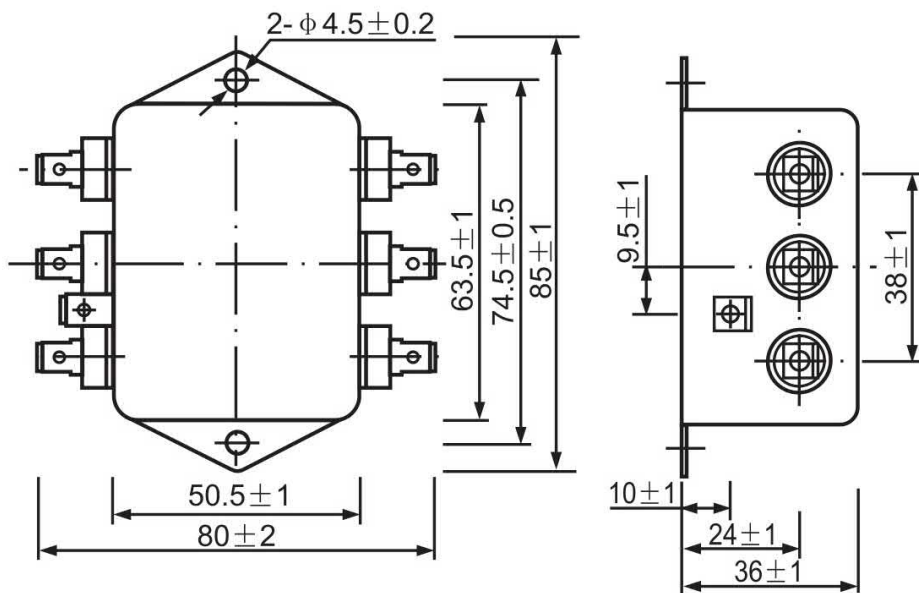

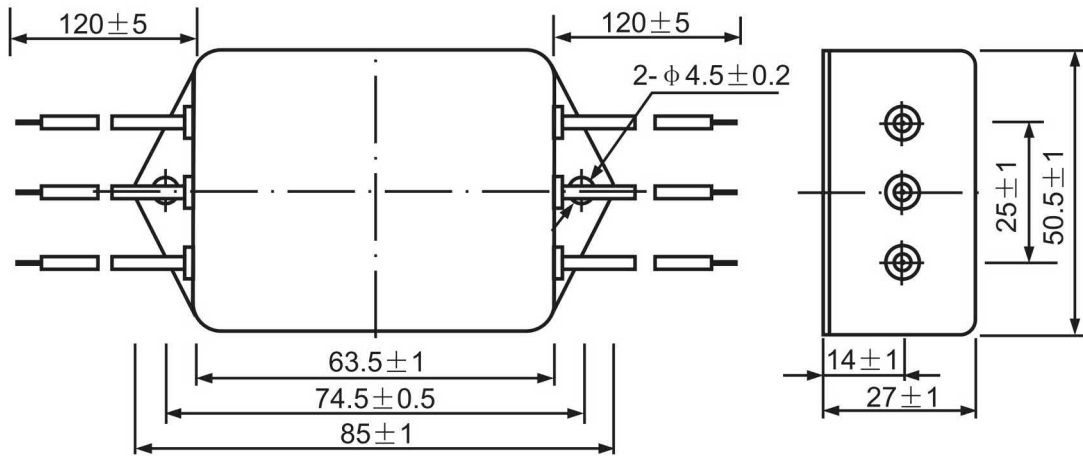

2

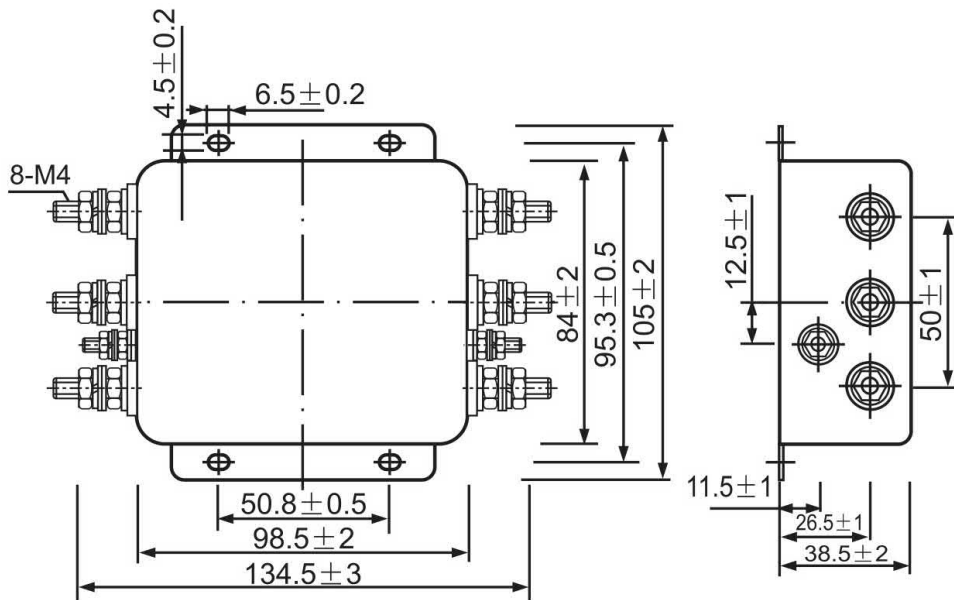

3

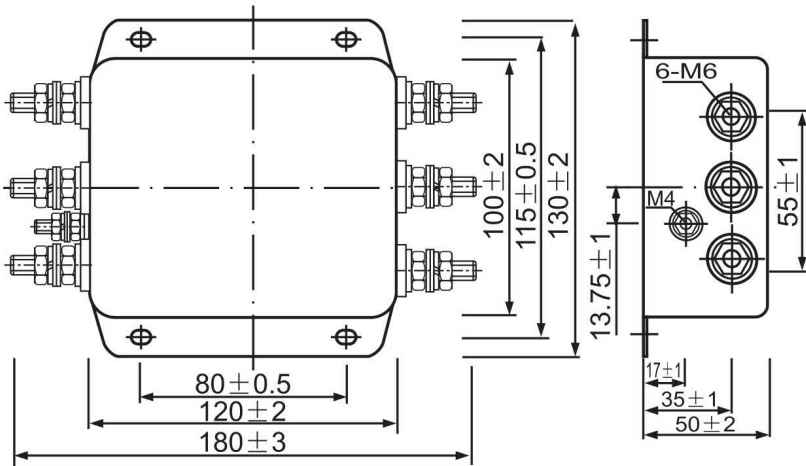

4

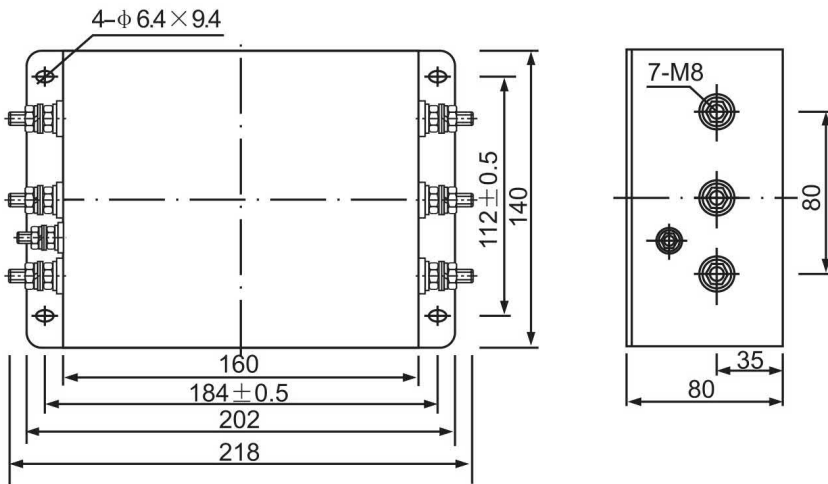

5

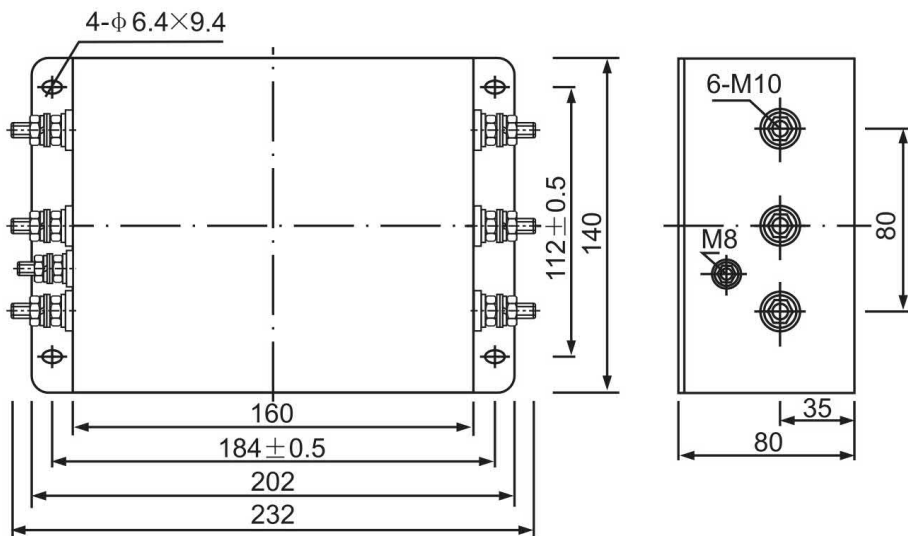

6

Metralytica GmbH
Oehleckerring 13
22419 Hamburg
Germany

www.metralytica.eu

+49 40 5936175-00
sales@metralytica.eu