

DZ Series

With IEC-Inlet

(1-16A)



Typical application

- Small electronic equipment and measuring instruments

Features and benefits

- IEC connector integrative filters
- Excellent performance/cost ratio

Conformity

- CE EN 60939
- CSA C22,2 | available on request for most types
- UL 1283 | available on request for most types
- Climatic category 25/085/21 (IEC 60068-1)

Technical specifications

	Symbol	Value	Unit	Remarks
Rated voltage	V_R	250	VAC	
Rated current	I_R	1 ... 16	A	
Ground capacitance		2.2 ... 10	nF	
Operating frequency	f_{op}	50/60	Hz	
Insertion loss		up to 90/100	dB	common/dfferential mode
Leakage current	I_l	0.5 ... 1.7	mA	
Operating temperature	T_{amb}	-25 ... +85	°C	
Storage temperature	T_S	-25 ... +85	°C	
Test voltage - line to line	V_{test}	1500	VDC	
Test voltage - line to ground	V_{test}	1500	VAC	

Electrical properties

Model	Connection		Rated Current [A]	Ground Capacitance [nF]	Leakage Current [mA]	Discharge Resistance [MΩ]	Circuit Diagram	Package Type
	Line	Load						
DL-1DZ2	So	F	1	2.2	0.5	-	1	1
DL-3DZ2	So	F	3	3.3	0.5	-	1	1
DL-6DZ2	So	F	6	3.3	0.5	-	1	1
DL-10DZ2	So	F	10	4.7	0.8	-	1	1
DL-15DZ2	So	F	15	2.2	0.5	1	1	1
DL-1DZ210	So	F	1	2.2	0.5	-	1	2
DL-3DZ210	So	F	3	2.2	0.5	-	1	2
DL-6DZ210	So	F	6	2.2	0.5	-	1	2
DL-10DZ210	So	F	10	2.2	0.5	-	1	2
DL-1DZX	So	L	1	2.2	0.5	-	1	3
DL-3DZX	So	L	3	3.3	0.5	-	1	3
DL-6DZX	So	L	6	3.3	0.5	-	1	3
DL-10DZX	So	L	10	3.3	0.5	-	1	3
DL-15DZX	So	L	15	2.2	0.5	1	1	3
DL-1DZ2C	So	F	3	2.2	0.5	-	1	4
DL-3DZ2C	So	F	3	2.2	0.5	-	1	4
DL-6DZ2C	So	F	6	2.2	0.5	-	1	4
DL-10DZ2C	So	F	10	2.2	0.5	-	1	4
DL-3DZB21	So	F	3	4.7	0.8	1.5	2	5
DL-6DZB21	So	F	6	4.7	0.8	1.5	2	5
DL-10DZB21	So	F	10	3.3	0.5	1.5	2	6
DL-15DZB2	So	F	15	3.3	0.5	1.5	2	7
DL-16DZB2	So	F	16	10	1.7	0.68	1	8

Legend: F = FASTON 6.3 So = socket L = lead

Circuit schematic

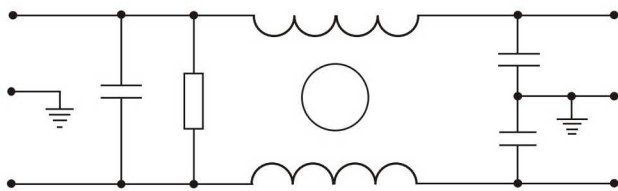

1

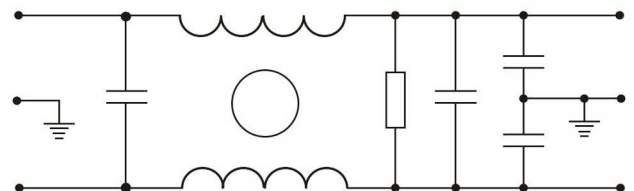

2

Insertion loss characteristics

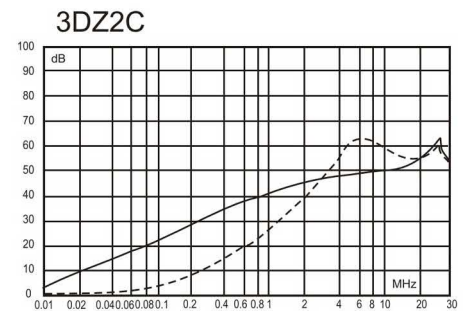
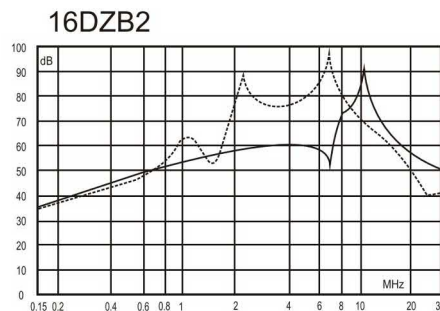
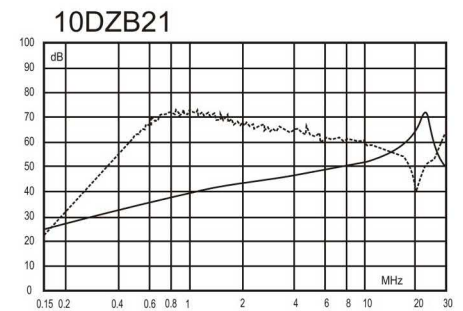
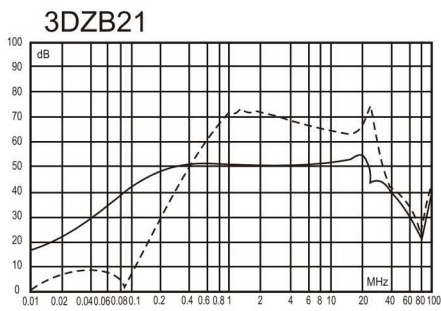
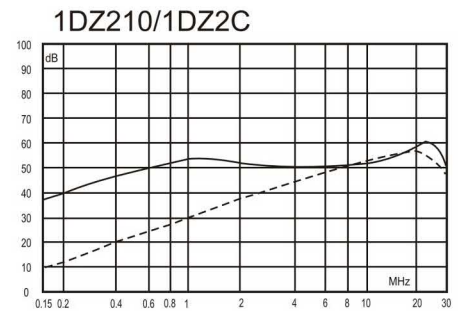
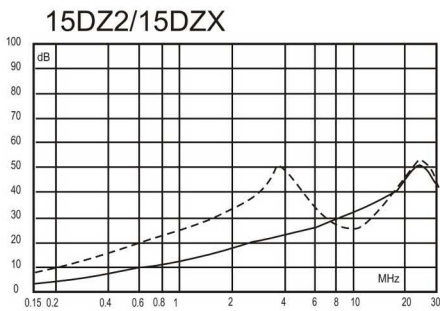
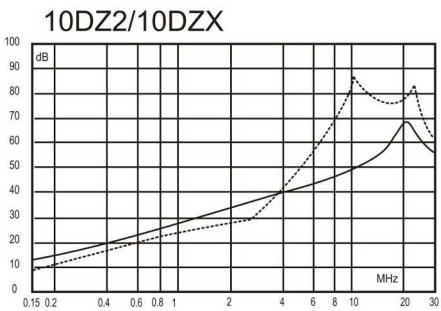
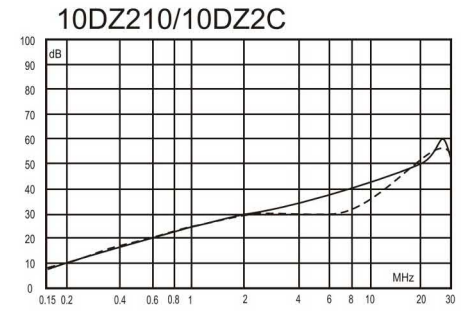
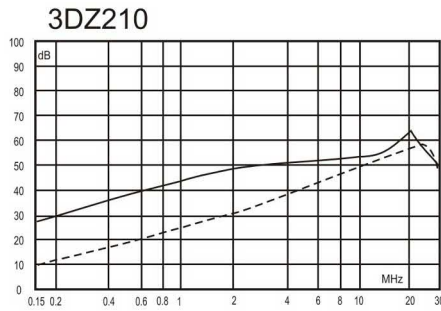
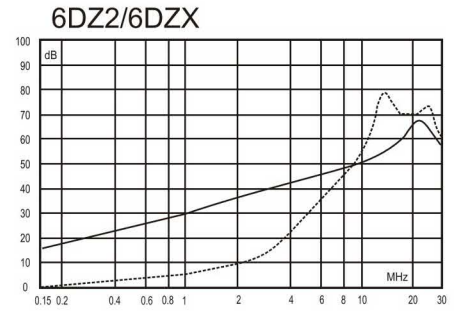
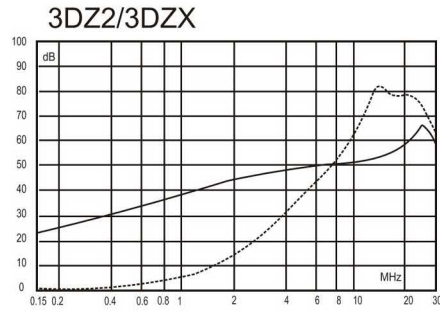
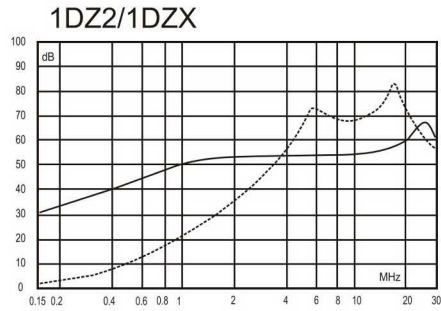

—— Common Mode
 - - - - Differential Mode

Mechanical packaging

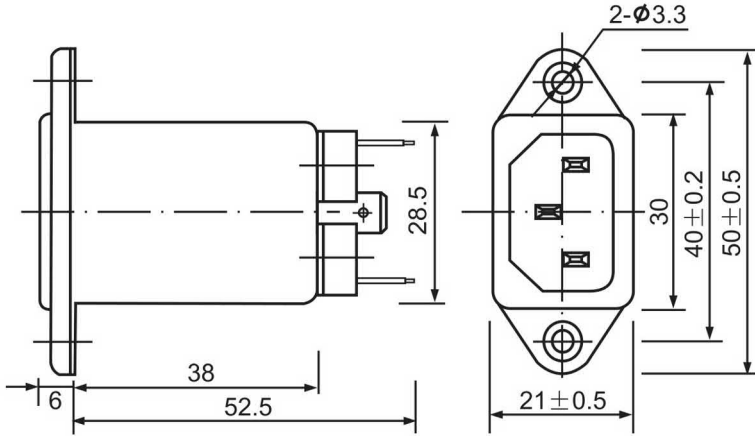

1

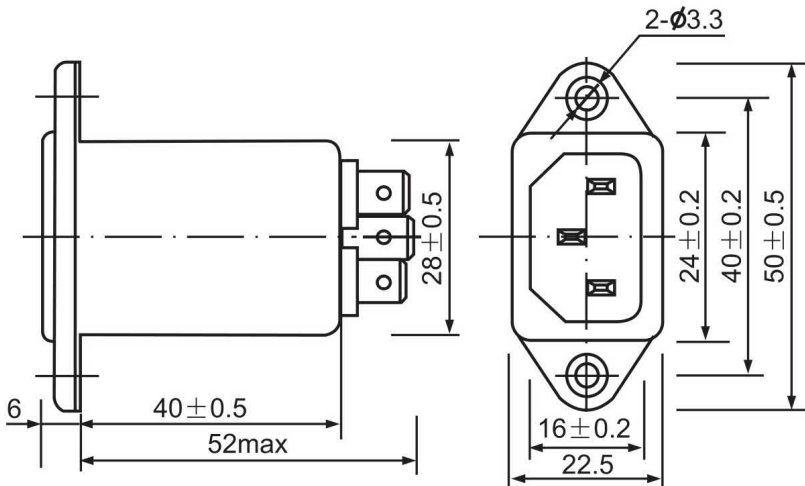

2

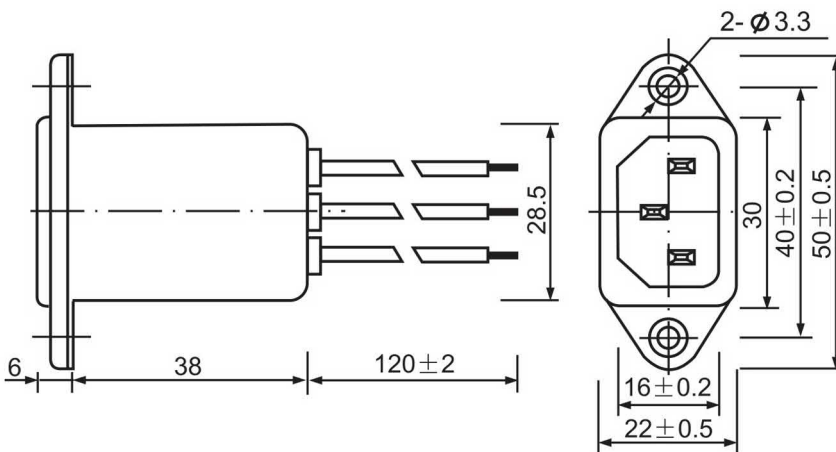

3

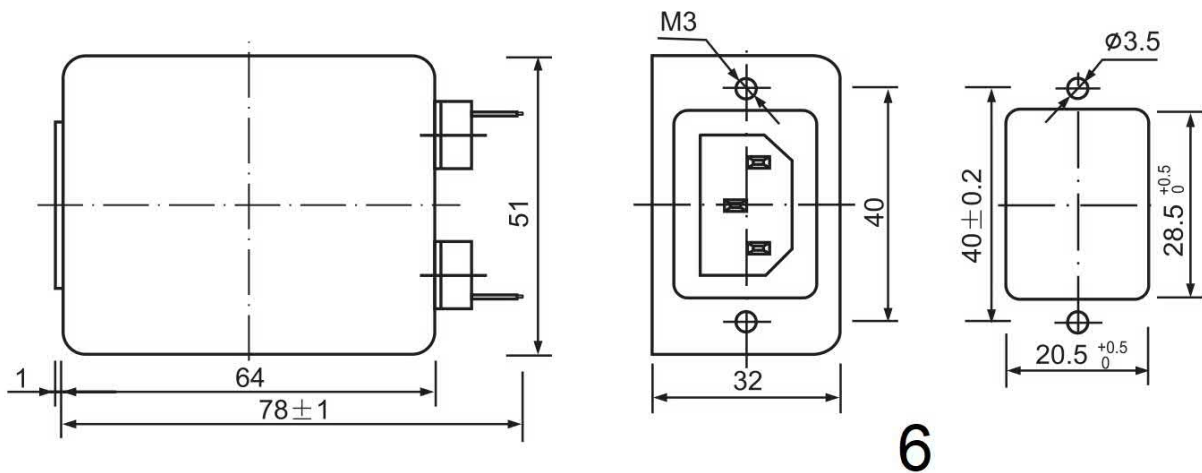
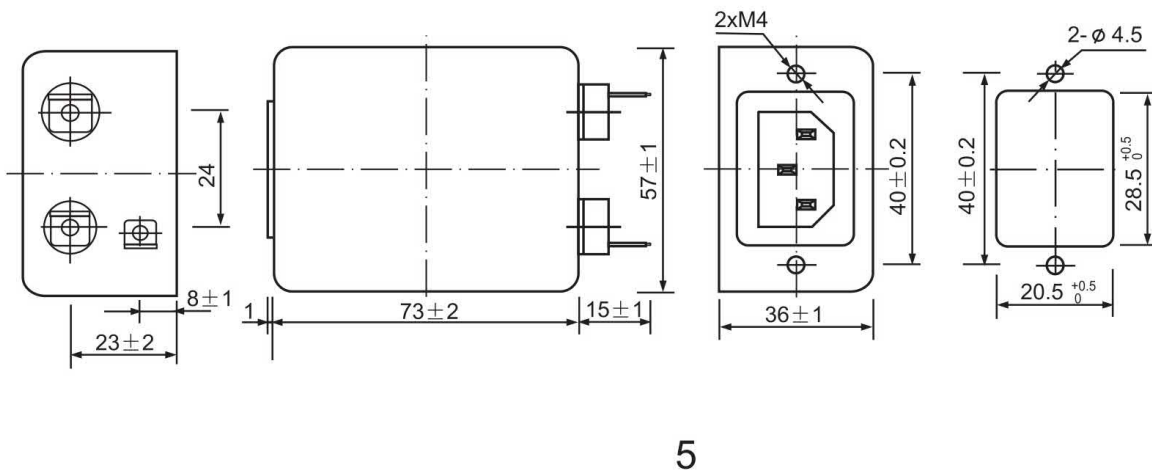
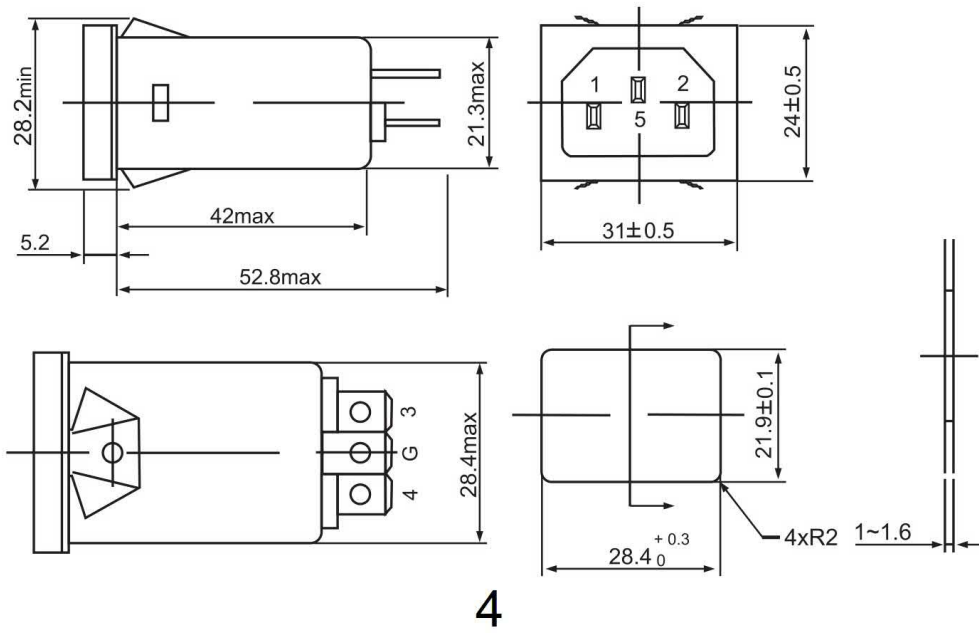

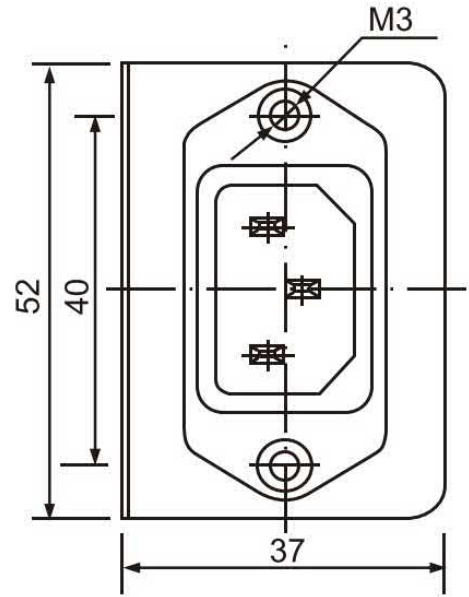
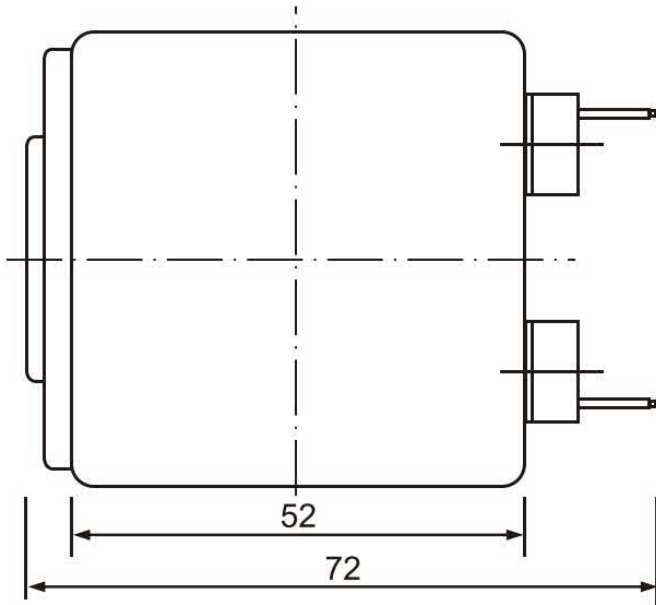

7

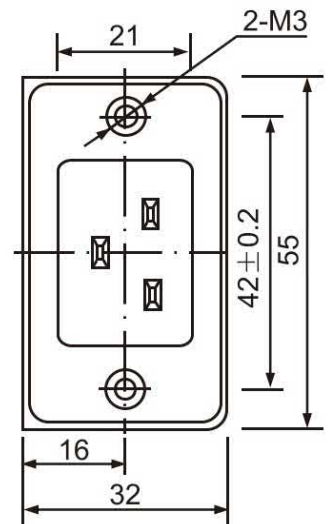
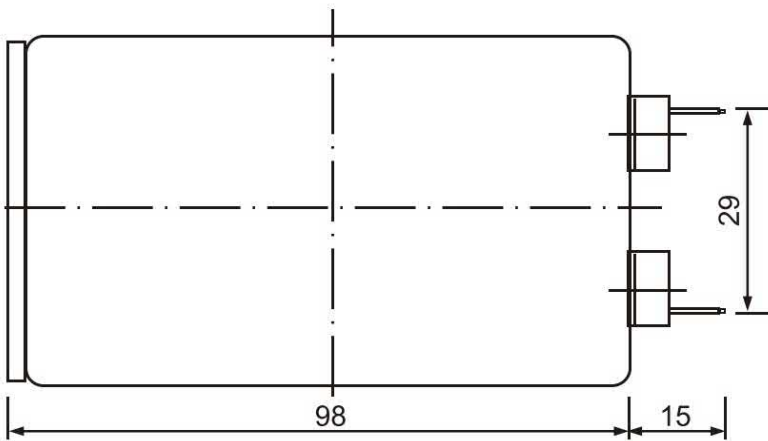

8

Metralytica GmbH
Oehleckerring 13
22419 Hamburg
Germany

www.metralytica.eu

+49 40 5936175-00
sales@metralytica.eu